

- Material: High-conductivity copper.
- Acceptable for direct burial.

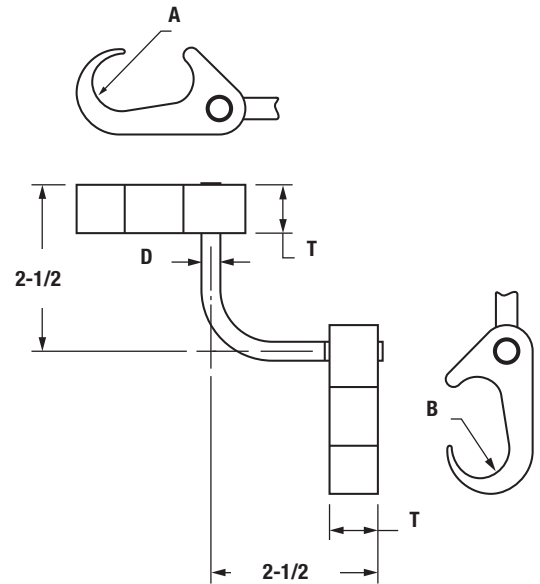

Cat. No.	A Cable Range	B to Cable Range	B to Ground Rod	B to Rebar	D (in.)	T (in.)	Dies for Tool*	
							A	B
54900L	250 kcmil–500 kcmil	250 kcmil–500 kcmil	5/8 in.–3/4 in. rod	#5–#6 (5/8 in.–3/4 in.)	3/4	1-1/8	15G121R	15G121R
54895L	#2 str.–250 kcmil				1/2		15G86R	15G126R
54885L	#6 sol.–#2 str.				5/8		15501A	15G126R
54875L	#2 str.–250 kcmil	#2 str.–250 kcmil	1/2 in.–5/8 in. rod	#3–#4 (3/8 in.–1/2 in.)	1/2	3/4	15G86R	15G86R
54865L	#6 sol.–#2 str.	#1 str.–250 kcmil			5/16		15501A	15G86R
54855L	#6 sol.–#2 str.	#6 sol.–#2 str.	–	–	5/16			15501A

*Use hydraulic tool 13100A, TBM14CR-LI, TBM14M, TBM15CR-LI, TBM15, or TBM15I or with die marked on cat. no. Use 15500TB adaptor for 15-Ton Tool TBM15I.

* Number of crimps.

